



Invitation for Bid No. 2025-008

Septic Owner-Occupied Repair Program

.....

ADDENDUM No. 2

ISSUE DATE: September 13, 2024

Responding Offerors on this project are hereby notified that this Addendum shall be made a part of the above named IFB document.

The following items add to, modify, and/or clarify the IFB documents and shall have the full force and effect of the original Documents. This Addendum shall be acknowledged by the Offeror in the IFB document.

Notice to Bidder

1. This Addendum is issued pursuant to the Conditions of the Solicitation and is hereby made part of the Contract Documents. The addendum serves to clarify, revise, and supersede information in the IFB. The Bidder shall acknowledge receipt of this Addendum in the appropriate space on the Bid Form. Failure to do so may subject the Bidder to disqualification. A list of attachments, if any, is part of this document.

Add/Delete Section

1. **Delete 5th Bullet Point, Section 7.2 Nesbit Road, Waxhaw, NC**, “Effluent pump that can deliver a minimum of 25gpm @ 20ft total dynamic head (TDH).”

Add to Section 7.2 Nesbit Road, Waxhaw, NC, “Effluent pump that can deliver a minimum of 39gpm @ 20ft total dynamic head (TDH)

2. **Add to Section 6** Scope of Work, “Each project location cannot exceed \$30,000 total lump sum.”
3. **Delete Section 10** Appendix A – Bid Form

Add Attachment 1, Revised Section 10 Appendix A – Bid Form. (Use this form to submit bid.)

4. **Delete Section 13** Appendix D – Construction Authorization Permit No. 23-103, Brooks Road.

Add Attachment 2, Revised Section 13, Appendix D – Construction Authorization Permit No. 23-103, Brooks Road.

5. **Delete Section 14** Appendix E – Construction Authorization Permit No. 23-228, Nesbit Road

Add Attachment 3, Revised Section 14, Appendix E – Construction Authorization Permit No. 23-103, Brooks Road.

End of Add/Delete Section

Questions/Answers Section

1. How long does it take to receive funds?

Answer: Payment for each location is available after final inspection. A pay request along with a sales tax form should be submitted to the Union County Project Manager for approval. Generally, payment is made within a week to 10 days. Terms will be included in the contract agreement.

2. Is there money offered upfront before the project begins to be used for materials?

Answer: No.

3. Will change orders be accepted?

Answer: No. Based on the Scope of Work, Specifications and instructions provided in the bid document, a turn-key, total lump sum, not to exceed \$30,000 per project, should be submitted for each project location.

End of Questions/Answers Section

Attachments

1. Revised Appendix A – Bid Form (Submit this form with Bid package.)
2. Revised Appendix D – Construction Authorization Permit No. 23-103, Brooks Road
3. Revised Appendix E – Construction Authorization Permit No. 23-228, Nesbit Road
4. Pre-Bid Sign-In Sheet

End of Addendum 2

ATTACHMENT 1, REVISED APPENDIX A – BID FORM

IFB No. 2025-008 Septic Owner-Occupied Repair Program

SUBMIT WITH BID

This Bid Form must be completed in its entirety as-is, signed by an executive of the company that has authority to contract with Union County, NC, and submitted with bid.

Based on the Scope of Work, Specifications and instructions provided in this solicitation, provide a Turn-Key, Total Lump Sum to complete the project as described. The Total Lump Sum includes an amount considered by Bidder to be adequate to cover Contractor’s overhead and profit for the complete project outlined in this solicitation. **Each project location cannot exceed \$30,000 Total Lump Sum.** Bidder’s may not write-in exceptions or additional expenses.

Project Location	Total Lump Sum
Septic Repair at 2901 Brooks Road, Wingate, NC	
Septic Repair at 7200 Nesbit Road, Waxhaw, NC	
Septic Repair at 2913 Waxhaw Indian Trail Road, Waxhaw, NC	
Total Bid	

Provide the following information:

Septic System Installer Certification Number _____

NC Secretary of State ID Number _____

Time of Completion

Number of Days to Substantial Completion after Notice to Proceed _____

Liquidated Damages Rate (from Agreement): \$150/day for additional time in excess of the days listed above by Bidder. Bidder accepts the provision of the Agreement as to Liquidated damages.

Bid Package Checklist:

The following items are submitted and made a condition of this Bid:

Appendix A – Revised Bid Form

Appendix B - Bid Submission Form (signed)

Appendix C - Addendum and Anti-Collusion form (signed)

Technical Data/Specification Documents (cut sheets) (Section 7)

Warranty Information & Duration (Section 7.4)

**Scope of work for septic system repair at
2901 Brooks Rd, Wingate, NC**

Please refer to Construction Authorization Permit #23-103 for details for the installation of the repair. The following itemized list should be used to facilitate the scope of work required.

- Existing 1000-gallon septic and pump tanks will need to be pumped out by an approved septage hauler and properly abandoned (crushed and filled). This is a requirement of the Construction Authorization Permit.
- A new 1000-gallon septic tank to be installed and connected to existing plumbing from the house. Assume 20' of 4-inch Sch40 with appropriate fitting will be required.
- Approximately 250' of 3-inch Sch40 with appropriate fittings for the supply line and distribution lines.
- New D-box with appropriate speed levelers
- Approximately 8 yards of #57 washed stone or equivalent to backfill 10' sections of each drain line.
- Disconnect supply line from existing camper. No plumbing from the camper will be allowed to connect to the new septic tank.
- Connect washing machine drain pipe into the plumbing for the septic tank.

Installation must be performed by a certified septic system installer with the State of North Carolina and all components of the system must be in accordance with the construction standards per 15A NCAC 18 A .1900 of the North Carolina Rules Governing Sewage Treatment and Disposal Systems.



Construction Authorization (Residential) Improvement Permit On-Site Wastewater

CA Permit Number: 23-103
IP Number: _____
Expiration Date: 3/7/28
System Classification: ILC
Tax Parcel #: 03-144-018A
Zoning: _____

CA only CA/IP

The construction and installation requirements of The North Carolina Laws and Rules for Sewage Treatment, And Disposal Systems, 15A NCAC 18A .1900 are incorporated by reference into this permit and shall be met. Systems shall be installed in accordance with the system layout.

Owner: Karla Richmond
 Mailing Address: 2901 Brooks Rd, Wingate, NC 29174
 Phone: (704) 314-5901 (c), _____ (h)
 Email: karlarichmond@yahoo.com

Property Location: 2901 Brooks Rd
 Subdivision: _____
 Lot#: _____
 Directions: _____

Type of CA or CA/IP: _____
 New Repair Addition/Expansion _____
 Design Waste Flow: 360 (gpd)
 Residential: Single Family Number of Bedrooms: 3 Water Supply: New Well _____ Shared Well _____ Existing Well _____ Other _____
 Number of Occupants: 6 max Basement: Yes No Basement Fixtures: Yes No

Installation Specifications Initial (Type): Tank + Distribution LTAR: ILC
 Alternative: _____ LSS/Engineer Design: _____
 Soil Depth: _____ Slope: _____ Area (sq. ft.): _____ Total Length: _____ Line Length: _____ # of Lines: _____
 Line Width: _____ Max. Depth of Lines: _____ Max. Grade: _____ Spacing: _____ Aggregate Depth: for 10'
 Distribution: D-Box Additional Cover: _____ Septic Tank: 1,000 Gal Pump Tank: _____ Pump: _____
 Certified Operator Required Yes (No)
 Diversion Drain: Length: _____ Depth: _____ Aggregate Depth: _____

Repair (Type): _____
 LTAR: _____
 Area: _____
 Notes: _____

This Construction Authorization is subject to revocation if the site plan, plat, or the intended use changes. The permit holder is responsible for checking with appropriate governing bodies in meeting their requirements. The Construction Authorization shall not be transferred when there is a change in ownership of the site. This Construction Authorization is subject to compliance with the provisions of the Laws and rules for Sewage Treatment and Disposal and to the conditions of this permit.

If applicable: I understand the system type specified is different from the type specified on the application. I accept the specifications of this permit.

Owner/Legal Representative Signature: [Signature] Date: 3/7/23
 Authorized State Agent: Heath R. Grayson Date: 3/7/23 Inspections Completed by: _____ Date: _____

* All plumbing (black + grey water) to be tied into new septic tank at time of installation

* Disconnect Plumbing from RV to the Septic System.

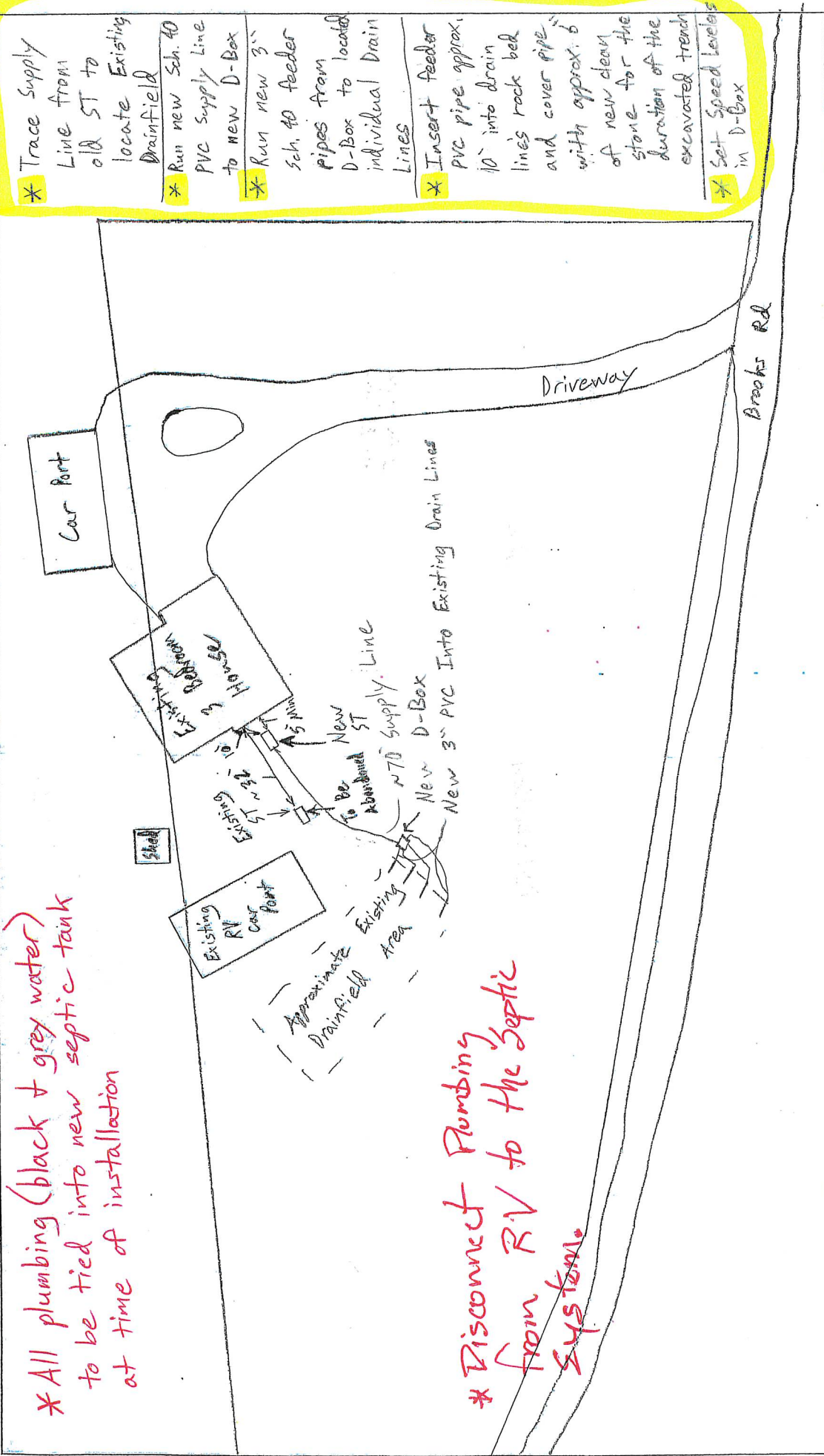

- * Trace Supply Line from old ST to locate Existing Drainfield
- * Run new Sch. 40 PVC Supply Line to new D-Box
- * Run new 3" sch. 40 feeder pipes from D-Box to located individual Drain Lines
- * Insert feeder PVC pipe approx. 10' into drain line's rock bed and cover pipe with approx. 6" of new clean stone for the duration of the excavated trench
- * Set Speed Levels in D-Box

CA Permit #: _____ Property Location: 2901 Brooks Rd Scale: NTS North

Absolutely no construction shall occur while soil is in a wet condition. Install lines on contour. Keep vehicular traffic off of system areas (initial and designated repair). A pre-construction meeting is required prior to installation. For scheduling, contact the EH office by 4pm on the business day prior to the date of pre-construction meeting or installation inspection at unioncountyeh@unioncountync.gov. Keep all utilities (including irrigation systems) 10 feet outside of system area. Certified Operator Required? Yes No



Environmental Health

500 N. Main Street
Suite #47
Monroe, NC 28112

T. 704.283.3553
unioncountyeh@unioncountync.gov
www.unioncountync.gov

Union County Environmental Health On-site Wastewater System Abandonment Procedure

To abandon a wastewater system location, follow these steps:

1. Have an approved hauler pump the liquid, sludge, and scum from all the tanks in the system.
2. The tank(s) should be abandoned by a Certified Septic Installer, licensed plumber, licensed public utilities contractor, or the owner of the property where the tank(s) is/are located. Three ways to abandon the tanks are listed below:

*Disinfect with chlorine or lime prior to removing, filling or crushing the tank(s).

A. Remove the tanks.

B. Fill in the tank in one of two ways:

1. Fill in entire tank with concrete. Must cap off inlet and outlet pipe penetrations first.
2. Cap off inlet and outlet pipe penetrations with concrete, fill in entire tank with sand or pea gravel, and then cap off both inlet and outlet access openings with concrete.

C. Crush tank in place. Break up bottom of tank so water does not pond on top. Fill in area with clay, sand or pea gravel. Pack material to ensure settling complete.

3. Backfill the excavation with clean clay material to natural grade and establish a vegetative cover.
4. Disconnect power at the source to all electrical controls and remove all controls and panels.
5. Remove all parts of the drain field on the ground surface (such as valves, valve boxes and risers), backfill the area to a natural grade and establish a vegetative cover.
6. Coat all surface areas exposed to effluent with hydrated lime and establish a vegetative cover.
7. Recommend to wait at least 18 months before using the disposal area for gardening or construction.

Scope of work for septic system repair at 7200 Nesbit Road, Monroe, NC

Please refer to Construction Authorization Permit #23-228 for details for the installation of the repair. The following itemized list should be used to facilitate the scope of work required.

- Existing 1000-gallon septic and pump tanks will need to be pumped out by an approved septage hauler and properly abandoned (crushed and filled). This is a requirement of the Construction Authorization Permit. Once this is completed, an abandonment verification will be issued to the property owner.
- A new 1000-gallon septic tank and 1000-gallon pump tank to be installed.
- NEMA 4x alarm/control box installed within eyesight of pump tank.
- Two manual disconnects for power supply that serve both pump controls and alarm will need to be installed within eyesight of pump tank, side of building adjacent to pump tank. The panel for power is approximately 15 feet from the exterior wall to mount manual disconnects. **The cost of any permits associated with an electrical inspection as well as the services that would be rendered by an electrician must be included.**
- Effluent pump that can deliver a minimum of 25gpm @ 20ft total dynamic head (TDH).
- 550 feet of schedule 40 2-inch PVC (supply line to drainfield)
- Pressure Manifold as depicted on Construction Authorization Permit #CA 23-228, including an appropriate turf box to allow for maintenance, as needed.
- 440 feet of an approved 'low profile chamber' trench material
- There are approximately 15 trees, 4-5 inches in diameter, that will need to be removed at the time drainfield is installed.
- Depending on the limitations of where the supply line crosses the driveway, an approved DOT pipe will be necessary to sleeve the 2-inch supply line. If the supply line can be installed at least 30 inches below grade at the driveway, no sleeve will be required.
- At least 8 inches of additional soil cover is required (silty clay or clay loam) on top of drainfield when covering. Must be landscaped to shed water away from drainfield area and seed/strawed to stabilize cover.
- 165 feet of 3-inch schedule 40 PVC and fittings to accommodate supply from pressure manifold to low profile drainlines.

Installation must be performed by a certified septic system installer with the State of North Carolina and all components of the system must be in accordance with the construction standards per 15A NCAC 18 A .1900 of the North Carolina Rules Governing Sewage Treatment and Disposal Systems.



Construction Authorization (Residential) Improvement Permit On-Site Wastewater

CA Permit Number: 23-22.8
IP Number: _____
Expiration Date: 5/19/28
System Classification: III B
Tax Parcel #: 04-347-001E
Zoning: RA-40

No FEE
CDBG Program

CA IP/CA

Owner: <u>Deborah + Jeffery Crane</u>	Property Location: <u>7200 Nesbit Rd, Waxhaw, NC 28173</u>
Mailing Address: <u>7200 Nesbit Rd, Waxhaw, NC 28173</u>	Subdivision: _____
Phone: <u>(704) 351-9946</u> (c), <u>980-347-8768</u> (h)	Lot#: _____
Email: <u>tipnpage@gmail.com</u>	Directions: _____

Type of CA or CA/IP: New <input type="checkbox"/> Repair <input checked="" type="checkbox"/> Addition/Expansion <input type="checkbox"/>	Design Waste Flow: <u>360</u> (gpd)	Water Supply: Public <input type="checkbox"/> New Well <input type="checkbox"/> Shared Well <input type="checkbox"/> Existing Well <input checked="" type="checkbox"/> Other _____
Residential: <u>Single Family</u>	Number of Bedrooms: <u>3</u>	Number of Occupants: <u>6 max</u>
	Basement: <input type="checkbox"/> Yes <input type="checkbox"/> No	No Basement <input type="checkbox"/> Yes <input type="checkbox"/> No

Installation Specifications Initial (Type): <u>Pump to Low Profile Chambers</u>	LTAR: _____	Repair (Type): _____
Alternative: <input type="checkbox"/> LSS/Engineer Design: _____	LTAR: _____	LTAR: _____
Soil Depth: <u>20"</u> Slope: <u>3%</u> Area (sq. ft.): <u>320</u> Total Length: <u>440'</u> Line Length: <u>Variable</u> # of Lines: <u>5</u>	Max. Grade: <u>Level</u> Spacing: <u>9' OC</u> Aggregate Depth: <u>N/A</u>	Area: _____
Line Width: <u>36"</u> Max. Depth of Lines: <u>8"</u> Max. Grade: <u>Level</u> Spacing: <u>9' OC</u> Aggregate Depth: <u>N/A</u>	Septic Tank: <u>1,000 Gal</u> Pump Tank: <u>1,000 Gal</u> Pump: <u>TBD</u>	Notes: _____
Distribution: <u>Manifold</u> Additional Cover: <u>6-8"</u> Septic Tank: <u>1,000 Gal</u> Pump Tank: <u>1,000 Gal</u> Pump: <u>TBD</u>		
Certified Operator Required Yes (No) <u>NO</u>		
Diversion Drain: Length: _____ Depth: _____ Aggregate Depth: _____		

This Construction Authorization is subject to revocation if the site plan, plat, or the intended use changes. The permit holder is responsible for checking with appropriate governing bodies in meeting their requirements. This Construction Authorization is subject to compliance with the provisions of the Laws and rules for Sewage Treatment and Disposal and to the conditions of this permit.

If applicable: I understand the system type specified is different from the type specified on the application. I accept the specifications of this permit.

Owner/Legal Representative Signature: _____	Date: <u>5-19-2023</u>
Authorized State Agent: <u>Heath R. Strayhorn</u>	Date: <u>5/19/23</u>

Inspections Completed by: _____
Inspection Number: 1704.283.3553
Environmental Health: 500N Main Street, Monroe NC 28112
unioncountyhealth@unioncountync.gov

PRESSURE MANIFOLD - MIN. 4" SCH 80
 (IN A BOX BROUGHT SIX INCHES ABOVE GRADE)

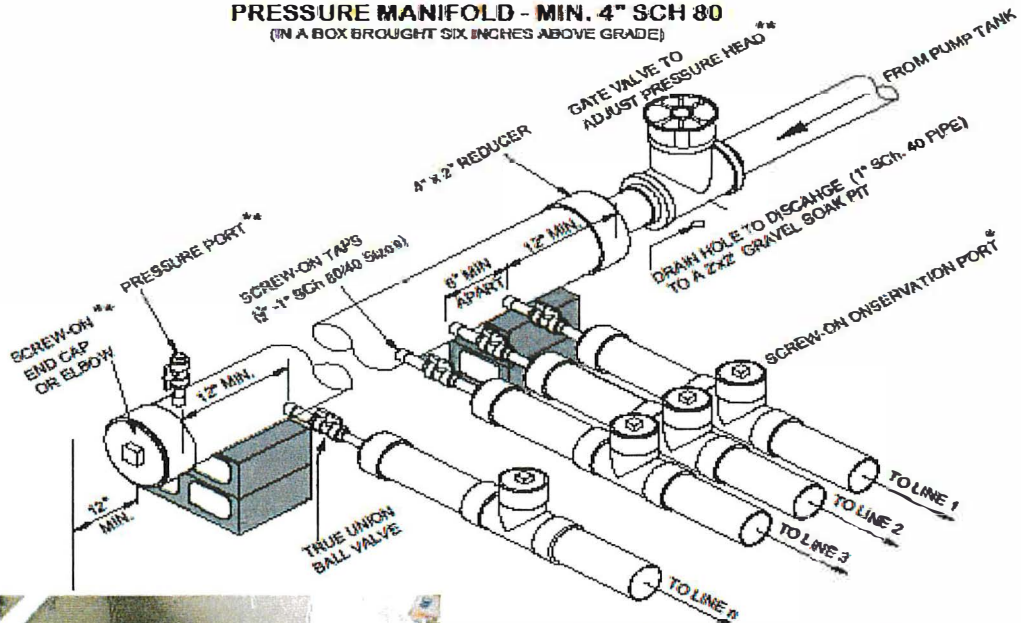

- ** MAY BE LOCATED INSIDE OR OUTSIDE MANIFOLD BOX. WHEN LOCATED OUTSIDE VALVE BOX IS REQUIRED.
- * MAY BE INSIDE BOX OR IF OUTSIDE, BRING 6" ABOVE GRADE

LINE #	TAPS	LENGTH
1	1/2" Sch 40	85'
2	1/2" sch 40	80'
3	1/2" sch 40	80'
4	3/4" Sch 80	115'
5	1/2" Sch 40	80'



Pressure Manifold Detail
 Union County

Design:	Date:	File Name:
Revision:		Pressure Manifold Detail
Approved:		Drawing No.
		1/1
	No Scale	Sheet 1 of 1

Union County Environmental Health On-Site Wastewater System Septic Tank & Pump Tank Abandonment Procedure

Following steps are necessary when abandoning a septic tank & pump tank:

1. Have an approved hauler pump the liquid, sludge and scum from all the tanks.
2. The tank (s) should be abandoned by a Certified Septic Installer, licensed plumber, licensed public utilities contractor or the owner of the property where the tank (s) are located.

Three ways to abandon the tanks are listed below:

- A. Remove the tanks.
- B. Fill in the tank (s) in one of two ways:
 1. Fill in the entire tank with concrete. Must cap off inlet and outlet pipe penetrations first.
 2. Cap off inlet and outlet pipe penetrations with concrete, fill in entire tank with sand or pea gravel, and then cap off both inlet and outlet access openings with concrete.
- C. Crush tank in place. Break up bottom of tank so water does not pond on top. Fill in area with clay, sand or pea gravel. Pack material to ensure settling complete.

**Disinfect with chlorine or lime prior to removing, filling or crushing the tank (s)*

3. Backfill the excavation with clean clay material to natural grade and establish a vegetative cover.
4. Disconnect power at the source to all electrical controls and remove all controls and panels.
5. Remove all parts of the drainfield on the ground surface (such as valves, valve boxes and risers), backfill the area to a natural grade and establish a vegetative cover.
6. Coat all surface areas exposed to effluent with hydrated lime and establish a vegetative cover.
7. Recommend to wait at least 18 months before using the abandonment area for gardening or construction.



